

Bird's Eye View

Conservation. Education.
Community.



Inside:
Nature Center
Expansion Underway

Jordan River Nature
Center Map Detail

Message from the Nest

Aldo Leopold's "Thinking Like A Mountain" essay in *A Sand County Almanac* helped many of us understand that relationships exist in nature among different parts of the ecosystem. Robin Wall Kimmerer's

Braiding Sweetgrass drove home the realization that humans have always played an active role in shaping ecosystems through agriculture, fire management, and selective harvesting. Suzanne Simard's *Finding the Mother Tree* describes how trees rely on an underground network to support their direct tree relatives as well as other species of trees.

These wonderful stories emphasize that relationships matter, and that systems can be complex, multi-faceted, and hard to fully understand. As Tracy Aviary launches into Phase II of the Jordan River Nature Center, these are lessons that will serve us well as we face the challenges ahead.

In the face of a historic drought, our first challenge is to transform approximately 12 acres of parched landscape, that has been mostly ignored for decades and is filled with invasive plants, into beautiful gardens that provide habitat for birds and insects, and will inspire curiosity and caring among our guests, volunteers, and staff.

Our second challenge is to create a nature-based community center in South Salt Lake that is welcoming to all, especially those who live close by because this community simply has less access to cultural assets than others in our

valley. To do this we need to build relationships and create programs that are responsive to the needs and wants of the community, and that it will take time and learning to do this well.

The final challenge is building this multi-million-dollar Jordan River Nature Center during tough times with supply chain issues, rising inflation, labor shortages, and a construction boom with COVID barely in our rear-view mirrors. We appreciate that to be successful we will need the support of the public and private sector, in big ways and in small ways, and that success might be hard to detect at first but will become apparent in time. 🌱

Cover: Wilson's warblers can be seen along the Jordan River during spring and fall migrations.

Above: Orb Weaver



Tim Brown
President/CEO, Tracy Aviary

BOARD OF TRUSTEES

Maria Estrada, PhD
-Chair

Melanie Battistone, PhD
-Secretary

Jim Dreyfous
-Treasurer

Darris Howe
-Past Chair

Kristin Riker
-ex officio

Tim Brown
-ex officio

Reza Ahmadi, PhD

Victoria Bacon

Tom Barton

Alyssa Dairsow

Metta Driscoll

Mary Essuman

Moana Palelei HoChing

Emily Leah

Larry Madden

John Malooly

Mary Pendergast, PhD

Jared Turner

Kēhaulani Vaughn, PhD



Jordan River Nature Center Update

Phase II Expansion

After several months of working through necessary processes and permits, Phase II of the Jordan River Nature Center (JRNC) is poised to start construction to expand its footprint by several acres. The entire property will be secured with an 8' fence similar to our Liberty Park campus. Infrastructure (irrigation and electricity) will be placed and main paths will thread through Phase II connecting a new 1000 West parking lot with our current campus.

Land sculpting will remove the existing weed saturated topsoil and replace it with berms topped with better soil ready for thousands of plants and trees that will create more beauty for guests. Our first significant garden area, the Utah Conservation Loop, was designed with the help of community members from Great Salt Lake Audubon, Salt Lake Air Protectors and Tracy Aviary's Volunteer Corps who developed initial conceptual designs. Located in the southern portion of the campus, this garden will feature native and drought tolerant plants that provide habitat for birds and insects.

Just north of the Utah Conservation Loop will be The ALSAM Foundation Observation Tower and a Wildlife Viewing Blind to be used as a classroom to teach about birds, and much more. To the east will be an Outdoor Amphitheater intended as a performance space for theater, music, and spoken word. The Emma Eccles Jones Pavilion, to the northeast, will provide a shaded space for school field trips, classes or family reunions.

Once construction is completed, our Jordan River Nature Center will be ready for all sorts of activities including educational programs, private events, school field trips, family reunions, Birding 101 class, and outdoor performances. Nature play spaces for the young and walking paths and areas for the older incorporated into the design will provide a much needed respite from the surrounding hustle of the city.

We are eager for construction to begin, and excited for what the future will bring. If you'd like more information about naming opportunities, please contact development@tracyaviary.org. 



Above: The Outdoor Amphitheater is intended as a performance space for theater, music, and spoken word.

Below: Tracy Aviary volunteers weed a native plant garden along the Jordan River Parkway Trail. In addition to creating habitat for birds and insects, these gardens allowed staff to test which native and drought tolerant plants would thrive in future gardens at the Jordan River Nature Center.





Jordan River Nature Center

Phase I (Existing) Phase II Phase III Phase IV

Proposed Buildings

A West Classroom (Existing)
B Bike Storage (Existing)
C West Restroom (Existing)
D Security Gatehouse
E PV Covered Parking Pavilion & EV Charging
F Outdoor Amphitheater
G The Emma Eccles Jones Pavilion

H Conservation Base Station & Restrooms
I The ALSAM Foundation Observation Tower / Wildlife Viewing Blind
J Visitors Center
K The Bobo Eco Learning Lab
L Service Building
M Small Pavilion
N Concessions / West Entry Kiosk
O Observation Tower

Proposed Site Features

1 Entry Plaza
2 Habitat Demonstration Garden
3 Serviceberry Picnic Area
4 Edible Gardens
5 Shade Forest
6 Pollinator Garden
7 Event Meadow
8 Waterwise Demonstration Garden
9 Beaver Lodge

10 Adler Wildflower Garden
11 Conservation Loop Natural Area
12 Culinary Foodscape Garden
13 Mudplay Area
14 Climbing Wall
15 Adventure Course
16 Eagle Perch
17 Boat / Bike Storage - Bike Repair

JORDAN RIVER

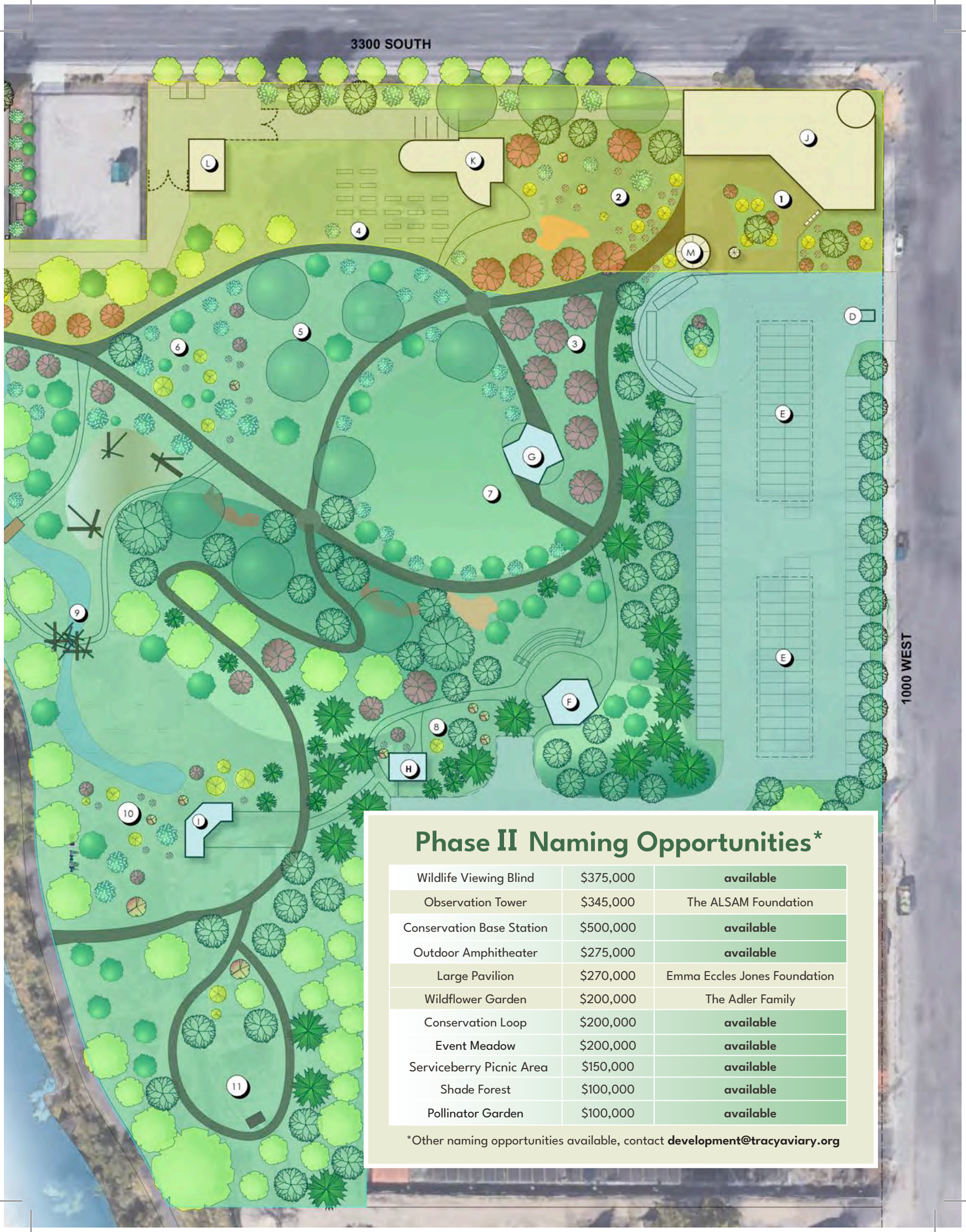

Phase II Naming Opportunities*

Wildlife Viewing Blind	\$375,000	available
Observation Tower	\$345,000	The ALSAM Foundation
Conservation Base Station	\$500,000	available
Outdoor Amphitheater	\$275,000	available
Large Pavilion	\$270,000	Emma Eccles Jones Foundation
Wildflower Garden	\$200,000	The Adler Family
Conservation Loop	\$200,000	available
Event Meadow	\$200,000	available
Serviceberry Picnic Area	\$150,000	available
Shade Forest	\$100,000	available
Pollinator Garden	\$100,000	available

*Other naming opportunities available, contact development@tracyaviary.org

Thank you to Donors

January 1 through
August 29, 2022

\$1000+

The Adler Family
Ingrid & John
Blankevoort
Angela Dean &
Tim Brown
Benita Pulins &
Ken Corneliusen
Kristi Ragsdale &
Steve DeBois
Ms. Metta Driscoll
Maria Estrada
Mary Pendergast &
Chris German
Meghan & Thomas
Higgins
Tres & Cheri Jones
Mike Keller
Lori Kinzer
Ann & John Malooly
Forrest & Laura
McNabb
Rebecca Raybould &
Aksel Peterson
Jennifer Speers
Amy & Ryan Taylor
Margie & Theron
Tempest

\$500-\$999

J. Bert Bunnell
Fabiana Cesa
Stephen Denkers
Dave Engel
Arlene Hamburg
Jean & Karl
Hendrickson
Darris & Gail Howe
Barbara Eastman &
Tom Kimbrough
Vicki & Dave Mackay
Sally Patrick
Ashley Patterson
Scott Robinson
Rich & Bridget
Romano
April & Rocky
Schutjer
Tiffini & Ben
Sorcic
Arminda Spencer
Deborah Stone

Betsy Thornton
Jared & Campbell
Turner
Jeffery & Azure
Wolfe

\$100-\$499

Charles M. & Leslie
Scopes Anderson
Bonnie E Avery
Brandon Ayala
Holly Bartimus
Christine Best
Gaby Bollman
Lisa Tomlin &
Marty Boynton
Carol Brady
Deanna Budion
Letitia Buroker
Glenna Chappell
Barbara Chavira
Jen Curti
Kiersten Dart
Jeff Dean
Anne Decker
Aline Devaud
Katie Dobkowski
Kirsten & Gary
Dodge
Anita Drew
Liam Duffy
Pat Evans
Catherine & Brad
Findlay
Ginger Fletcher
Barbara Hall
Karen & Shawn
Halladay
Francis & Joan
Hanson
Brad Hare
Melinda Heins
Courtney Henley
Lee Hitchcock
Karin & Lincoln
Hobbs
Karen & William
Hyde
Roger & Lisa
Jackson
Kathleen Johnson
Richard Kanner
Sandra Kinzer

Carl & Gilleen
Kjeldsberg
David Kliger
Bryan & Doris
Larsen
Gregory & Michele
Lesoine
Annika Lindner
Pam & Willy Littig
Nancy Talcott-Luty
& Christoph Luty
Kate Lyngle-Cowand
Larry Madden
Max, Mike & Mary
Malmquist
Fayth Martinez
Stacey Maxwell
David McDowell
Virginia McOmber
Amanda Meyer
Rick Miller
Amanda Murphy
John Neill
DeAnne Nielson
Ann & John
O'Connell
Mary Lynn Osborn
Sheryl Robinson
Carolyn Pedone &
John Rose
Margee & Mark Ruff
Karen Salazar
Mary & Mike
Sanders
Ann Schubert
Jonathan Seegmiller
Kim Sokolowski
Melissa Stamp
Edna & Jerald
Taylor
Lauri Taylor
Sharon Thompson
Vicki Turner
Alysia Watanabe
Susan Weisenberg
Hugh Wetmore
Katie Ullman &
Daniel Wettstein
Ben Wichser

\$50-\$99

Danielle Barnes
Bev Beck

Rebecca Bennion
Lynne Besbekos
Kathleene Bundy
Courtney Cavalieri
Carla Cicero Studley
Sam Cravens
Jarred Day
Jason Dee
Malia Deshotel
Elizabeth Ellis
Anna & Christopher
Fonnesbeck
Ann Greig
John Grow
Jonathan Jemming
Erin Johnson
Margaret Kaiser
Subhash Kithany
Natalie Liebhaber
Nita Ludwig
Jeff Lytle
Blaine Mathison
Olivia Meiring
Jana Moffitt
Rachel Russak
Kristin Ryan
Barbara Spiro
Jennie & Clark
Stacey
Peggy Stone
Patricia Stoppi
Ivan & Jennifer
Vining
Margaret Williams
Tara Wion
Elizabeth Wommack
Angela Snow &
Osama Youssef

\$1-\$49

Cecily A Lewis
Noelle Atkin
Kasper Bachman
Hope Believe-Vanore
Paul Bernard
Laura Book
Elias Brooks
Kira Bush
Joseph Campbell
Michelle Carroll
Becky Cheff
Saybra Christley

Darlyn Kate
Cristobal
Nicole Curtz
Lauren Dean
Kylee Ehmann
Sheila Ervin
Ebsa Eshete
Britt Fagerheim
Dawna Faulkner
John Flinchum
Valerie Frokjer
Teresa Gonzales
Kyle Hatch
Daryl Huff
Elaine Hultgren
Siera Jensen
Kylie Jones-
Greenwood
Melody Kester
Tierra Korb
Peyton Larsen
Steve Lira
Andrew Madden
Melody Liu
Zoe Massey
Sloane McNeill
Colleen & Jolene
Mewing
Cole Miller
Erika Minjarez
Avery Moore
John Murphy
Jaydn Nielsen
Chloe Nielson
Terri Pope
Melissa Raynes
Karla Reading
Cortnee Sahli
Makayla Shadle
Trista Shaw
Patricia &
Homer Smith
Monica Snow
TiA Tisdale
Janice Vander
Molen
David Wallgren
Kristan Warnick
Marissa Widdison
Whitney Wright

Corporate, Foundation, & Government Donors

AMD Architecture
ASLA Utah Chapter
Beehive Distilling
Blue Boutique
Bur Oak Foundation
Caffe Ibis
Castle Foundation
CCI Mechanical
Community Shares Utah
Cross Charitable Foundation
Emergent Solutions
Fabian VanCott
Great Salt Lake Audubon
Henry W. & Leslie M.
Eskuche Foundation

HomeLight
Herbert I. & Elsa B.
Michael Foundation
Jetpack Inc.
Jordan River Commission
Justice Outside
Key Bank
Kroger
Larry H. Miller & Gail Miller
Family Foundation
Living Home Construction
Melling Family Foundation
Network For Good
The Nature Conservancy
Parsons Behle & Latimer

Rain Bird Inc.
Red Hat
Rocky Mountain Power
Salt Lake City Arts, Culture &
Events Fund
The Salt Mine
SIRQ Construction
Sorenson Legacy Foundation
Stephen G. & Susan E. Denkers
Family Foundation
Theodore & Elizabeth Schmidt
Family Foundation
Third Sun
Tom Stevens Construction
University of Utah
Uintah Consulting

United Way of Central &
Southern Utah
Utah Associated Municipal
Power Systems
Utah Division of Arts & Museums
Utah Division of Forestry, Fire &
State Lands
Utah Office of Outdoor Recreation
Vine Lore
Wasatch Global Investors
Wild Birds Unlimited of SLC
Wilkinson Ferrari & Co
Willard L. Eccles Foundation
XMission
Zions Bank

Where there's a Will, there's a Way You Can Make a Legacy Gift through your Will

- Costs you nothing during your lifetime
- Preserves your savings and cash flow
- Can be changed or revoked as needed
- Allows you to be far more generous than you ever thought possible

A bequest is easy to arrange. Adding a simple paragraph to your will is all it takes.

Questions: development@tracyaviary.org, 801-596-8500 x112.

Leave a Legacy Join our Heritage Society

THE TRACY AVIARY HERITAGE SOCIETY honors and recognizes the philanthropic leadership and vision of individuals who create a planned giving strategy to benefit the mission of Tracy Aviary, forever. Too often, these gifts are unrecognized because they come at the end of the donor's life. Our Heritage Society allows us to celebrate and thank donors for their generosity, today! Examples of planned giving strategies include:

Bequest by Will • Charitable Gift Annuity • Charitable Remainder Trust
Life Insurance • Retirement Account Assets

If you have already included Tracy Aviary in your planned giving strategy, or would like to discuss your options with our staff, contact: development@tracyaviary.org, 801-596-8500 x112.



589 EAST 1300 SOUTH
SALT LAKE CITY, UT
84105

Birds & Spiders

A web of connections

- Of the more than 620 spider species that live in Utah, only seven have bites that are harmful to humans.

- Spiders are beneficial predators that eat mosquitoes that may carry the West Nile virus, which can be lethal for birds.

- Omnivorous birds like sparrows and crows eat spiders as an energy-rich snack.

- Several species of hummingbirds use spider webs as nesting material - the elasticity of the webs allow their nest to grow with their chicks!

- Spiderwebs have inspired the design elements found in bird-friendly glass. See this in action on two exterior windows at our Visitors Center in Liberty Park!

- At Antelope Island State Park, spiders are so important to the health of the park's habitat that they are celebrated annually during Spider Fest.

The presence of spiders is an indicator of the overall ecological health of an area. Jumping spiders are harmless to humans and are common in Utah.

More development@tracyaviary.org
info: tracyaviary.org 801-596-8500 x112



PRINTED ON 100%
RECYCLED PAPER